

SOCKETS

SOCKET SHOULDER SCREWS Stainless Steel

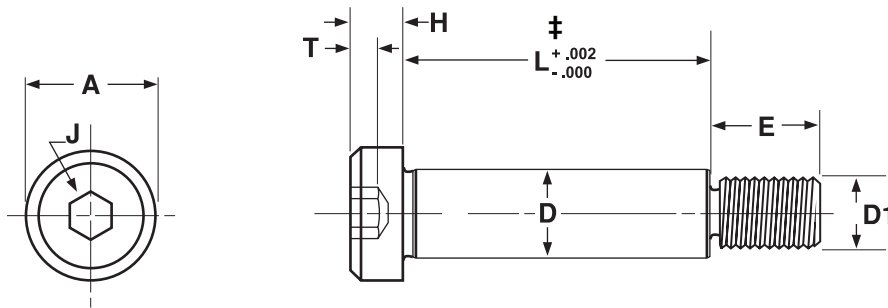

SOCKET HEAD SHOULDER SCREWS - ALLOY STEEL												
Nominal Size	D		A		H		J		T	E		D1
	Shoulder Diameter		Head Diameter		Head Height		Hex Socket Size		Key Engagement	Thread Length		Nominal Thread Size & Threads per Inch
	Max	Min	Max	Min	Max	Min	Max	Min	Min	Max	Min	
1/8	.1245	.1235	.254	.246	.135	.115	.080	.078	.062	.161	.151	4-40
5/32	.1560	.1550	.285	.277	.135	.115	.095	.093	.078	.192	.182	6-32
3/16	.187	.186	.316	.308	.166	.146	.095	.093	.078	.192	.182	8-32
1/4	.2495	.2485	.379	.371	.197	.177	.127	.125	.093	.255	.245	10-32

Description	A hex socket head screw with an enlarged, unthreaded, cylindrical shoulder under the head, the diameter of which serves as the basis for the derivation of the nominal size.
Applications/ Advantages	For rotation or sliding applications, such as pulley shafts, in punch and die work, or for use as a bearing pin. Shoulder screws are also referred to as "stripper bolts".
Material	18-8 Stainless Steel
Plating	Stainless shoulder screws are usually supplied passivated.

This page prints with a watermark